

# Quick Start Guide

## TX-NR616

### Supplied Accessories

Make sure you have the following accessories:

- ① Indoor FM antenna
  - ② AM loop antenna
  - ③ Speaker cable labels
  - ④ Remote controller and two batteries (AA/R6)
  - ⑤ Power cord (Taiwanese models)  
(Plug type varies from country to country.)
  - ⑥ Speaker setup microphone
- The AV receiver can automatically perform speaker and surround settings, so that you can easily enjoy a surround sound tailored to your listening environment. Connect the supplied microphone to the AV receiver and follow the on-screen instructions.

When performing automatic speaker setup, connect your TV to the AV receiver and make the room as quiet as possible.

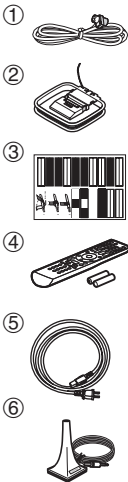

### Using the Remote Controller

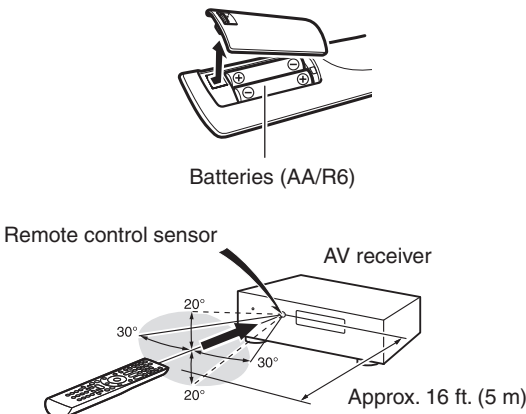

#### Note

Before connecting the power cord, connect all of your speakers and AV components.

## 1. Connecting Your Speakers

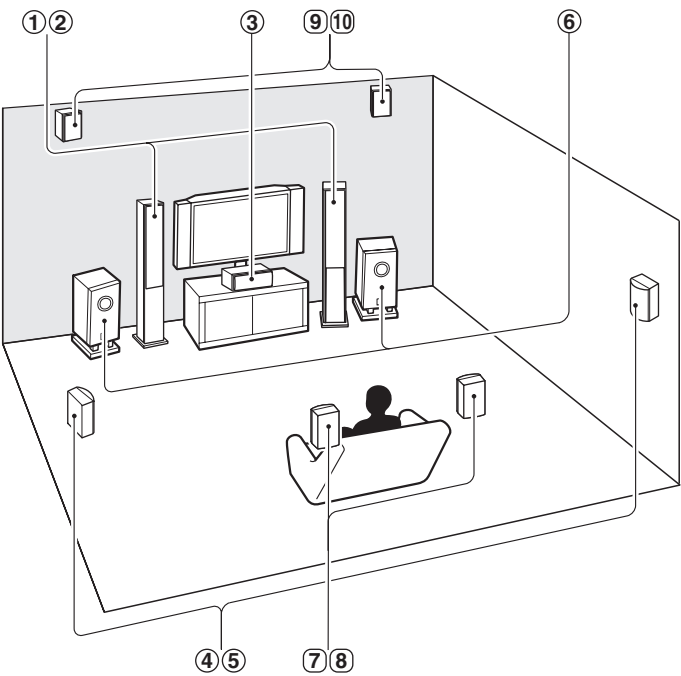

- ① ② Front speakers
- ③ Center speaker
- ④ ⑤ Surround speakers
- ⑥ Subwoofer(s)
- ⑦ ⑧ Surround back speakers
- ⑨ ⑩ Front high speakers

#### Speaker Configuration

- 5.1-channel: ① ② ③ ④ ⑤ ⑥
- 7.1-channel: ① ② ③ ④ ⑤ ⑥ + ⑦ ⑧
- 7.1-channel: ① ② ③ ④ ⑤ ⑥ + ⑨ ⑩

En



\* 2 9 4 0 1 0 2 2 \*

Please connect ①, ②, ③, ④, ⑤ and ⑥ for 5.1-channel surround.

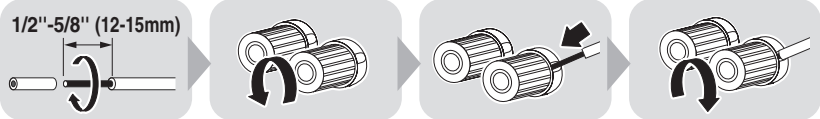
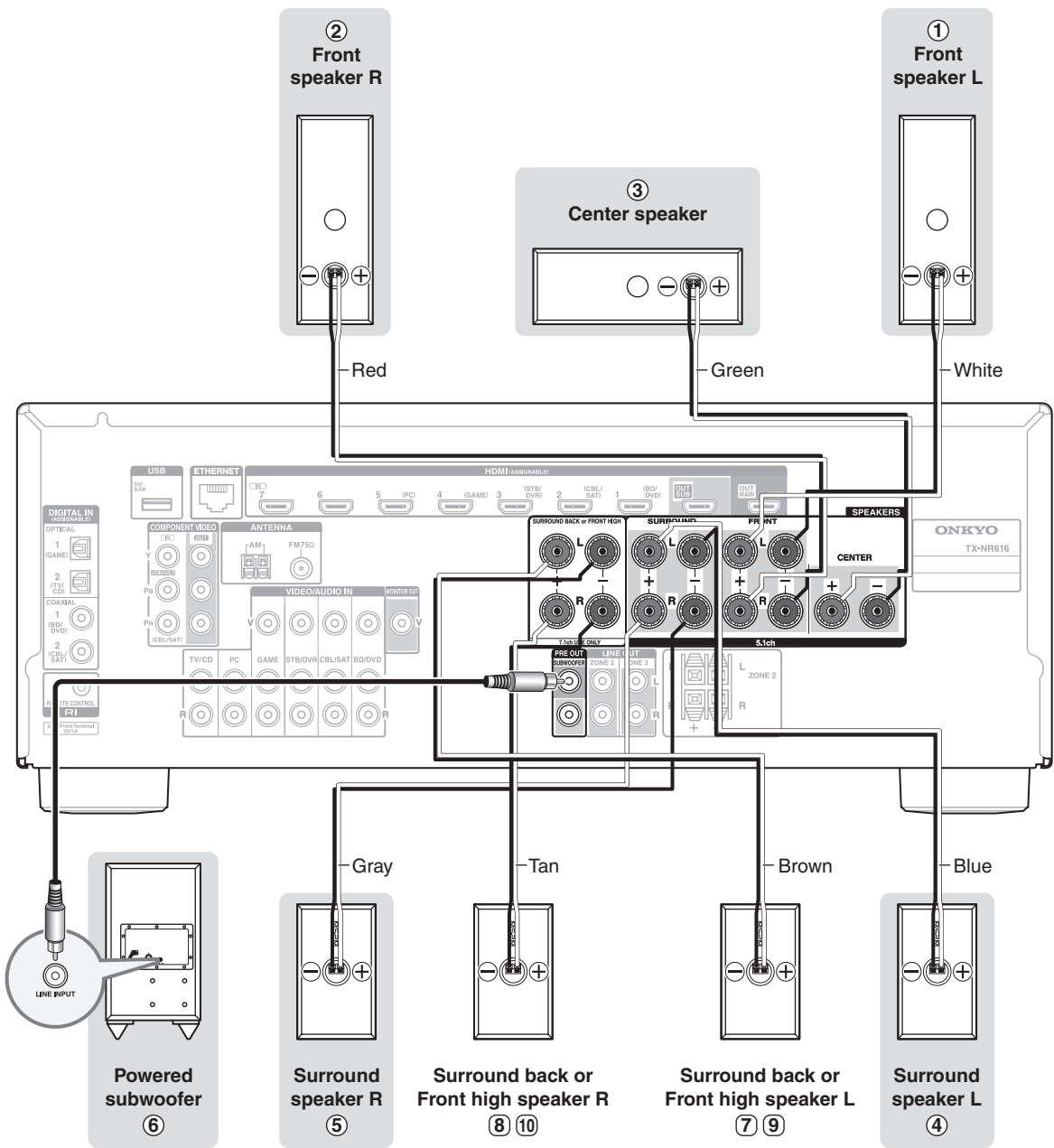

## 2. Connecting Your Components

### Connecting Components with HDMI

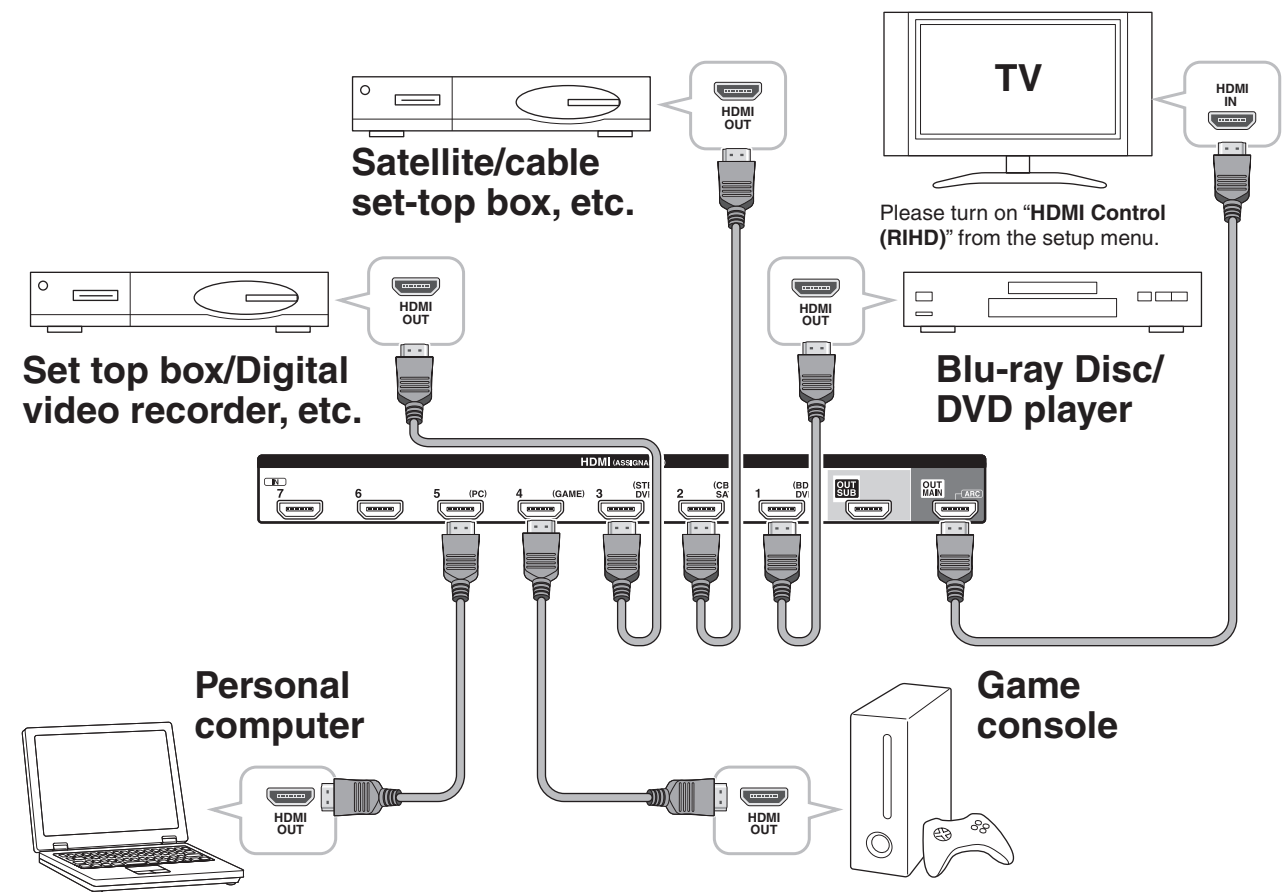

The components connected to each terminal (BD/DVD, GAME, etc.) can be selected with the input selector buttons of the same name on the front panel. Note that these default assignments can be changed. For details, please refer to the instruction manual.

#### ■ Listening to TV audio (Optional)

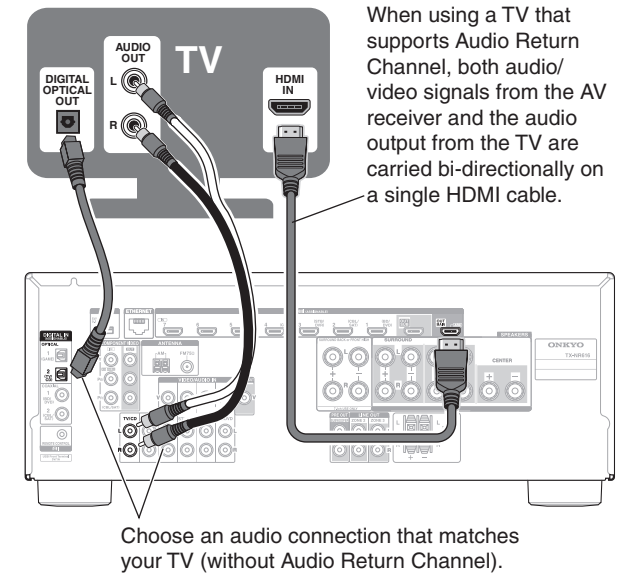

#### ■ Video upconversion to HDMI

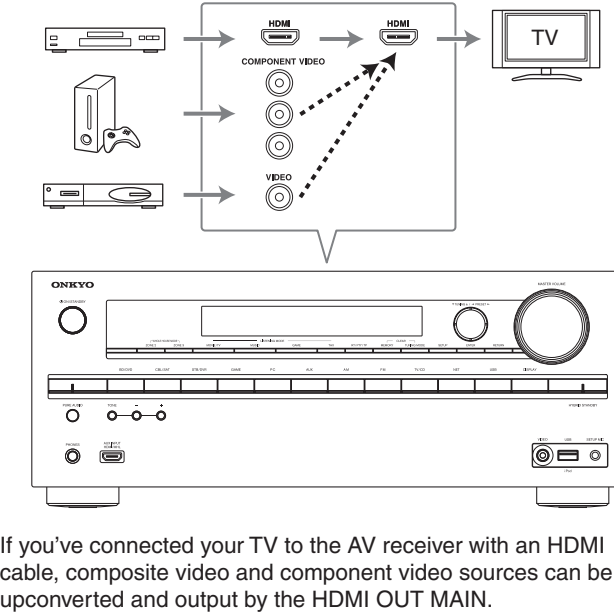

### Connecting Components without HDMI

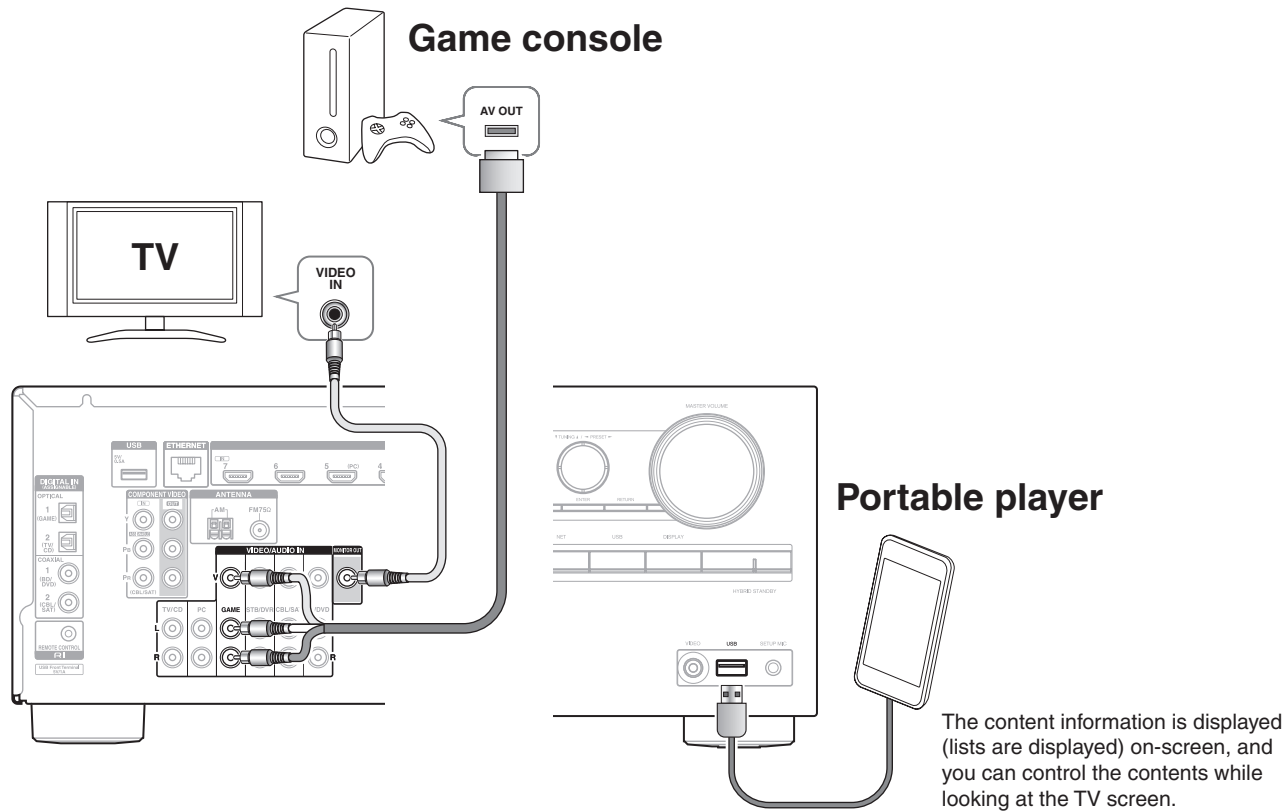

### Connecting to the Network (Optional)

The following diagram shows how you can connect the AV receiver to your home network. In this example, it's connected to a LAN port on a router, which has a 4-port 100Base-TX switch built-in.

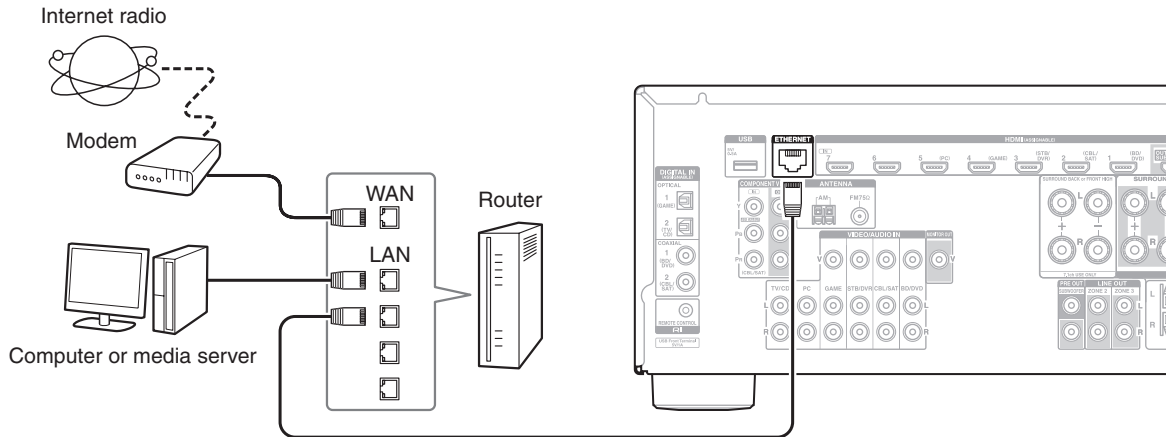

### 3. Turning On & Basic Operations

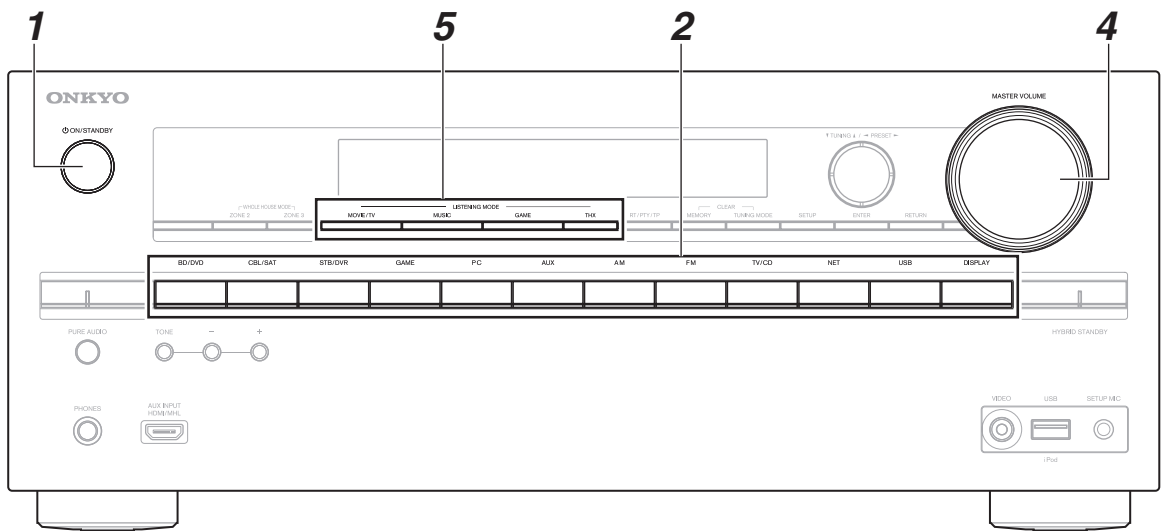

- 1 Turn on the AV receiver.
- 2 Select the input source.
- 3 Start playback on the source component.
- 4 Adjust the volume.
- 5 Select a listening mode and enjoy!

### 4. Using the Setup User Interface

The on-screen menus appear only on a TV that is connected to the **HDMI OUT MAIN**. If your TV is connected to other video outputs, use the AV receiver's display when changing settings.

#### Tip

- If the menu doesn't appear, make sure the appropriate external input is selected on your TV.

#### Quick Setup

The Quick Setup provides quick access to frequently used settings. You can change settings and view the current information.

##### ■ Opening the Quick Setup



##### ■ Navigating through the menus



##### ► Input

You can select the input source while viewing the related information.

##### ► Audio

You can change various audio settings such as tone controls, the subwoofer and center channel levels.

##### ► Information

You can view various information about the currently selected input source.

##### ► Listening Mode

You can select the listening modes that are grouped in categories.

##### ■ Closing the menu



#### Setup Menu (Home Menu)

The Setup menu provides extended setup that includes settings for advanced users. All the settings are organized in a user-friendly structure, which covers the whole TV screen area.

##### ■ Opening the Setup menu (Home Menu)

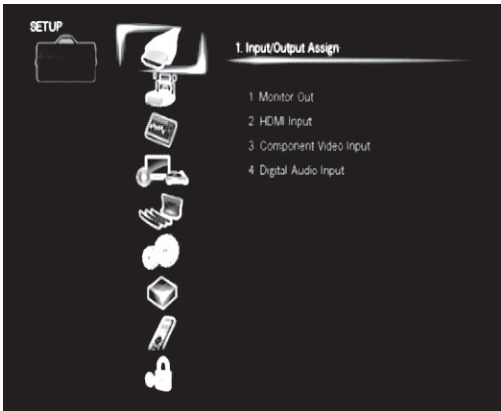

##### ■ Navigating through the menus



##### ■ Returning to the main menu



##### ■ Closing the menu



#### Note

- This procedure can also be performed on the AV receiver by using **SETUP**, the cursor buttons, and **ENTER**.

# 5. Getting to Know the AV receiver

## Front Panel

(North American and Taiwanese models)

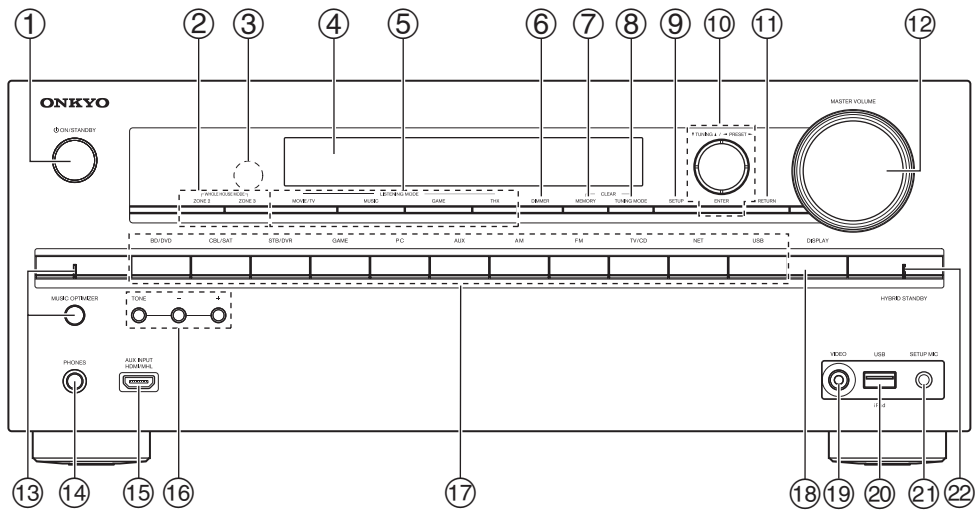

(European, Australian and Asian models)

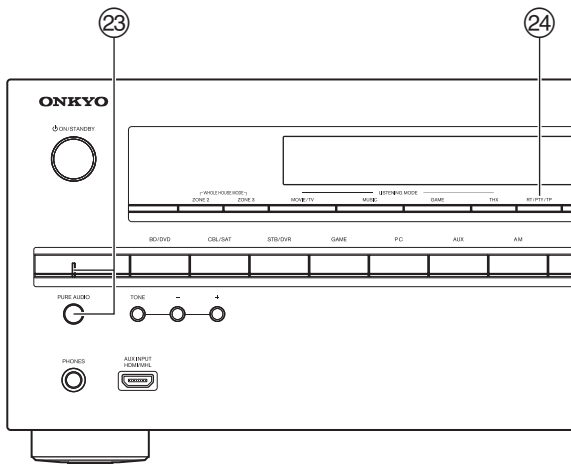

Each input selector button (**BD/DVD**, **GAME**, etc.) selects the input terminal with the same name on the rear panel.  
Note that these default assignments can be changed. For details, please refer to the instruction manual.

- ① Sets the AV receiver to On or Standby.
- ② Selects Zone 2/3.
- ③ The remote control sensor receives signals from the remote controller.
- ④ Displays various information.
- ⑤ Selects listening modes.
- ⑥ **(North American and Taiwanese models)**  
**DIMMER:** Adjusts the display brightness.
- ⑦ Stores or deletes radio presets.
- ⑧ Selects the Auto or Manual tuning mode.
- ⑨ Accesses the setup menus.
- ⑩ When the AM or FM input source is selected, ▼ **TUNING** ▲ are used to tune the tuner, and ◀ **PRESET** ▶ are used to select radio presets.  
When used with onscreen menus, they work as cursor buttons to select and set items. **ENTER** is also used with onscreen menus.
- ⑪ Returns to the previous menu.
- ⑫ Adjusts the volume.

- ⑬ **(North American and Taiwanese models)**  
The Music Optimizer function enhances the sound quality of compressed music files.
- ⑭ Connects a standard pair of stereo headphones.
- ⑮ Connects a camcorder or similar for audio/video playback.
- ⑯ Adjusts the tone.
- ⑰ Selects the input sources.
- ⑱ Displays various information about the currently selected input source.
- ⑲ Connects an iPod/iPhone.
- ⑳ Connects a USB storage or portable player for playback of music files.
- ㉑ Connects the speaker setup microphone.
- ㉒ Lights depending on the AV receiver's setting status.
- ㉓ **(European, Australian and Asian models)**  
Selects the Pure Audio listening mode.  
The indicator lights when this mode is selected.
- ㉔ **(European, Australian and Asian models)**  
**RT/PTY/TP:** Used for RDS (Radio Data System).  
RDS works only in areas where RDS broadcasts are available.

## Remote Controller

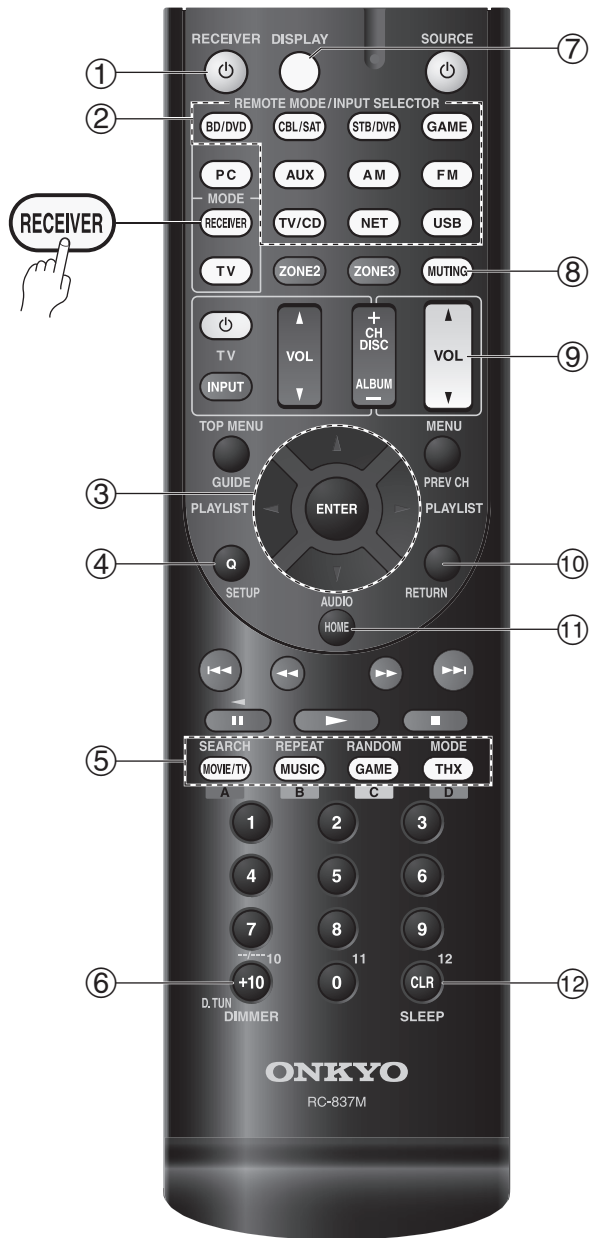

To control the AV receiver, press **REVERSE** to select Receiver mode.

- ① Sets the AV receiver to On or Standby.
- ② Selects the remote controller modes or the input sources.
- ③ Selects and adjusts settings.
- ④ Accesses the quick setup menus.
- ⑤ Selects listening modes.
- ⑥ Adjusts the display brightness.
- ⑦ Displays various information about the currently selected input source.
- ⑧ Mutes or unmutes the AV receiver.
- ⑨ Adjusts the volume.
- ⑩ Returns to the previous menu.
- ⑪ Accesses the HOME menu.
- ⑫ Used for the Sleep function.

## 6. Troubleshooting

### Can't turn on the AV receiver.

Make sure that the power cord is properly plugged into the wall outlet.

### The AV receiver turns off unexpectedly.

The AV receiver will automatically enter standby mode when Auto Standby is set and launched.

### There's no sound, or it's very quiet.

Make sure that the proper digital source is selected.

### There's no picture.

Make sure that all video connecting plugs are pushed in all the way.

If you can't resolve the issue yourself, try resetting the AV receiver before contacting your Onkyo dealer.  
To reset the AV receiver to its factory defaults, turn it on and, while holding down **CBL/SAT**, press ◻ **ON/STANDBY**. "Clear" will appear on the AV receiver's display and the AV receiver will enter standby mode.

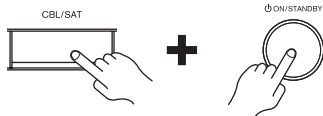

Note that resetting the AV receiver will delete your radio presets and custom settings.

## ONKYO

ONKYO SOUND & VISION CORPORATION  
Tel: 072-831-8023  
<http://www.onkyo.com/>

ONKYO U.S.A. CORPORATION  
Tel: 800-229-1687, 201-785-2600  
<http://www.us.onkyo.com/>

ONKYO EUROPE ELECTRONICS GmbH  
Tel: +49-8142-4401-0  
<http://www.eu.onkyo.com/>

ONKYO EUROPE ELECTRONICS GmbH (UK BRANCH)  
Tel: +44-(0)1628-473-350

ONKYO CHINA LIMITED  
Tel: 852-2429-3118  
<http://www.onkyochina.com/>

ONKYO CHINA PRC  
Tel: 86-21-52131366  
<http://www.cn.onkyo.com/>